



Item Code 78636

Digital Moisture Meter for Wood with Maximum and Minimum Hold Function **Instruction Manual**



Introduction

Thank you for purchasing Shinwa's Digital Moisture Meter for Wood with Maximum and Minimum Hold Function. Before using the product, please read the instructions contained in this manual to ensure correct use. After having read this manual, always keep it with you or in a safe place.

■Use

- For measuring the moisture content of wood

■Features

- Can record maximum and minimum moisture content values
- Can hold the measured value of moisture content
- Backlight function

■Specifications

Measurement Method	Electrical resistance
Measurement Range	Moisture Content: 6.8 - 60%
	Temperature: -10 - 50°C *1
	Humidity: 10 - 90% *1
Accuracy	Moisture Content: ±2%
Use Temperature	-10 - 50°C
Storage Temperature	-40 - 60°C
Resolution	Moisture Content: 0.1%
	Temperature: 0.1°C
	Humidity: 0.1%
Auto Power Off	Approx. 10 min. *2
Power Source	2x AAA batteries (Batteries included are for trial use only and may not last as long)
Material	Body: ABS resin, elastomer resin Measuring Probes: Stainless steel Button: Silicone rubber
Body Size	130×55×29 mm
Weight	144 g

*1 Since the accuracy of the temperature/humidity measurement function cannot be guaranteed, use as an approximation.

*2 When the device turns off due to the Auto Power Off function, the power button must be pressed twice to turn it on again.

■Accessory

- Storage case
- 2x AAA batteries

■Part Names

●Body

ON/OFF button

When the device is off, press once (or twice if the power automatically turned off) to turn the power on. A brief press will clear the recorded value, while a long press will turn off the power.

Change material button (▼)

Decreases the material number by 1.

Maximum value recall button

Causes the maximum moisture content value to be displayed until the device is turned off or the memory is cleared.

●Liquid Crystal Display

Humidity display

Displays the humidity.

Temperature display

Displays the temperature.

Maximum value display

Minimum value display

Moisture content

Protective cap

Be sure to attach the protective cap when not measuring.

Measuring probe

HOLD button

The moisture content currently being displayed will remain fixed.

Change material button (▲)

Increases the material number by 1.

Minimum value recall button

Causes the minimum moisture content value to be displayed until the device is turned off or the memory is cleared.

Backlight button

After pressing the backlight will stay on for approximately 10 minutes.

Material No.

Battery icon

Icon is displayed when little battery power is remaining.

Hold display

Moisture content bar graph



Caution

- Do not use other than as intended.
- Cannot be used to certify transactions.
- Cannot be used to measure liquids.
- The accuracies of measuring instruments are predetermined. Use this device in accordance with the usage situation. See the ■ Specifications section for information about the accuracy of this product.
- Accuracy of moisture content for objects other than wood cannot be guaranteed.
- For materials other than wood, the moisture content of the surface that is in contact with the measuring probes can be measured, but the moisture content inside cannot be measured.
- Measurement values can differ even with the same type of wood depending on the environment and conditions in which it grew.
- Do not drop or subject to strong impact as this may cause the device to operate incorrectly.
- Cannot be used to measure beyond the measuring range.
- Do not use in an environment that exceeds the device's operating temperature.
- Do not store at a temperature that exceeds the device's storage temperature.
- Do not alter or disassemble the device other than as directed in this manual.
- If the device gets dirty, wipe it clean with a soft cloth. Do not wipe with a volatile oil such as thinner, or alcohol.
- Keep out of the reach of children.
- Remove the battery when the device will not be used for a long time.
- Do not allow the device to get wet as it is not waterproof.
- The accuracy of this device's temperature/humidity measurement functions as well as material numbers 3-7 are not guaranteed.
- Use caution as the tip of the measuring probes are sharp and dangerous.
- After inserting the measuring probes into wood, wipe the measuring probes with a soft cloth to clean them.
- When replacing a measuring probe, take care not to over-tighten the nut.
- Be sure to attach the protective cap when not measuring.
- The device may experience malfunction due to the effect of electromagnetic waves or static electricity, and may display "Lo" regardless of the measurement value.
Do not use near objects that generate electromagnetic waves or static electricity.
- We shall not be liable for any consequential, incidental, or indirect damages such as losses and lost profits to the customer as well as a third party resulting from the operation of this product, regardless of whether or not they were foreseeable or the possibility was reasonably foreseeable.
However, this shall not apply in the case where there is willful or gross negligence or when the customer is a consumer according to the Consumer Contract Act. In the event that we are liable for the use of this product, we shall be liable for damages limited to an amount equal to the price of the product.

■ Before Using

Remove the film from the AAA batteries packaged in the storage case, and insert them into the device while referring to the ■ Changing the Battery section below.

■ Changing the Battery

The battery icon will turn on when the batteries are low. The device will not work when the battery is low. We recommend immediately replacing with 2 new AAA batteries.

- ① Use a Philips screwdriver to loosen the battery cover screw on the back of the device.

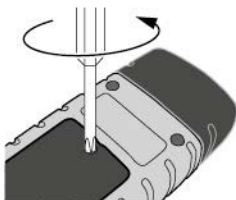

- ② Open the battery cover, and insert 2x AAA batteries in the correct position.

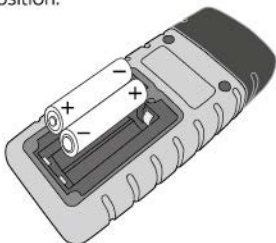

- ③ Replace the battery cover and tighten the battery cover screw securely.

■How to Use

①While the power is off, press the ON/OFF button.

*If the device turns off due to the Auto Power Off function, press the power button twice to turn on again.

If the power is turned off with the OFF button

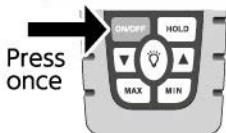

If the power is turned off due to Auto Power Off

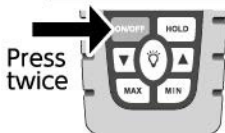

②Press the Change Material buttons (▼)(▲), and select the material number for the object to be measured.

Wood Material

No.1	Chestnut, Scots pine, cherry, Monterey pine, spruce, western hemlock, zelkova, walnut, Dahurian larch, birch, Japanese larch, larch, Douglas fir, beech, dragon spruce, Japanese red pine
No.2	Japanese cedar, tamarisk, Japanese cypress, Japanese maple, Sakhalin fir, oak, paulownia, Sakhalin spruce, ash, pink shower tree

Other Materials

No.3	Cement paste, concrete
No.4	Anhydrite
No.5	Mortar
No.6	Lime mortar, plaster
No.7	Brick

●Accuracy of moisture content other than wood is not guaranteed.

●For materials other than wood, the moisture content of the surface that is in contact with the measuring probes can be measured, but the moisture content inside cannot be measured.

- ③After removing the protective cap, insert the tips of the measuring probes at least 5 mm into the object and take a reading when the numerical value becomes stable.

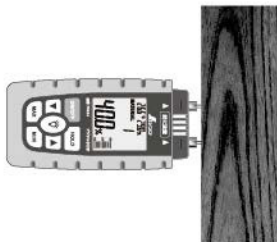

■ Maximum Value/Minimum Value Display Function

- Displays the maximum or minimum moisture content value until the device is turned off or the memory is cleared.



- *The maximum and minimum values will be reset by either changing the material number, using the Hold function, turning off the device, or clearing the memory.

■ Hold Function

- Pressing the Hold button causes the currently displayed numerical value of moisture content to remain fixed.

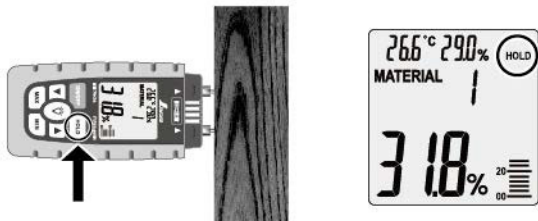

* Using the Hold function will reset the maximum/minimum values. Moreover, while the Hold function is being used the maximum/minimum values will not be displayed.

■ Clear Memory Function

- Press the ON/OFF button briefly while the power is on and all of the numerical values and settings will be reset, and the device will return to material No. 1 (if the backlight is already on it will then turn off).

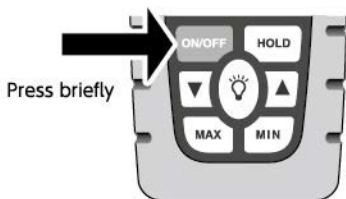

■ Troubleshooting

Problem	Remedy
The measuring probe is loose	See the ■ Changing the Measuring Probes section below and tighten it.
The measuring probe is rusty or damaged	Please purchase Item Code: 96061 Description: Needle pin 2 pc-pack for Digital Moisture Meter for Wood from a retailer that handles our products, and replace the probe while referring to the ■ Changing the Measuring Probes section below.
"Lo" is displayed	Either the device may not be measuring at all, or it may be affected by static electricity. Use a metal object to make contact with the device and discharge any static electricity before use.

■ Changing the Measuring Probes

- ① Loosen the measuring probe's nut with a wrench or other tool, and remove it.

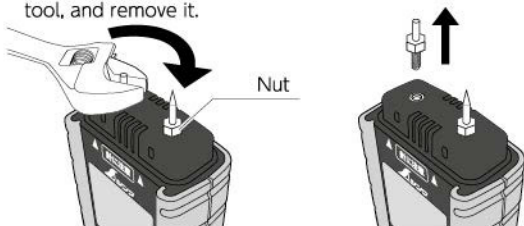

- ② Insert a new probe, and use a wrench or other tool to tighten the probe nut.

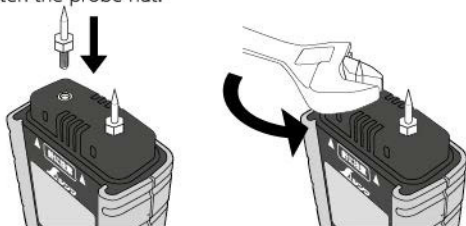

Shinwa Rules Co., Ltd.

<https://www.shinwasokutei.co.jp/english/>
3-18-21 Koya, Sanjo, Niigata, 955-8577 JAPAN
MADE IN CHINA