

Finding Stud Easily and Accurately

Stud Finder Basic 25 mm/ 35 mm/ 35 mm with Magnet/ 45 mm



No more loose screws

For installing handrails, curtain rods, or hanging heavy pictures, you need to know where your wall studs are. This stud finder is a great little tool that fits in your tool pouch and can find where the wood or iron (79025 only) stud is.

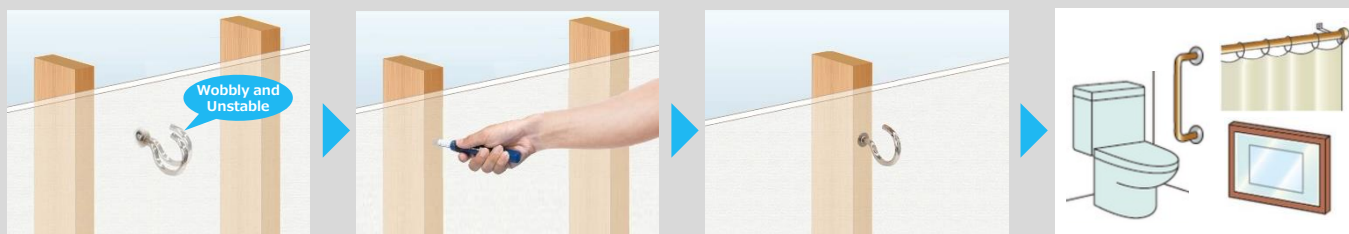

Via Needle

For stud made of wood.

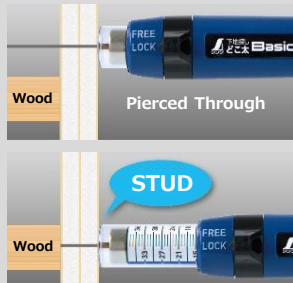

Via Magnet

For stud made of iron.

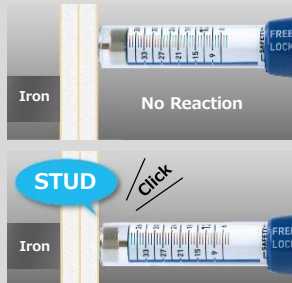

Large lock switch

The large lock switch could be turned on and off with just one hand, making work smoother and safer.

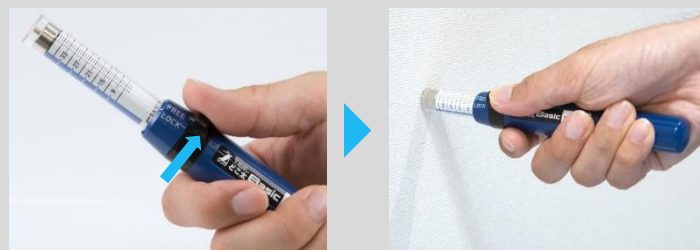

Stud Finder Basic

Code	Description	Packing Unit	JAN CODE
79023	25 mm	10	4 960910 790230
79024	35 mm		4 960910 790247
79025	35 mm with Magnet		4 960910 790254
79026	45 mm		4 960910 790261

■ Features

Code	79023	79024	79025	79026
Detectable wall thickness (needle)	25 mm	35 mm	35 mm	45 mm
Detectable wall thickness (magnet)	—		Wall thickness: 13 mm Ceiling thickness: 12 mm	—
Material	Body: ABS resin Movable Needle Cover: Polycarbonate resin, ABS resin, stainless steel, brass Needle: Stainless steel Magnet: Neodymium (79025)			