

Part Names and Features

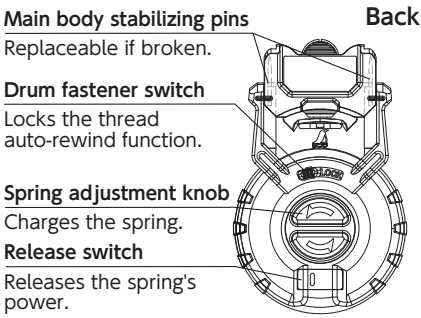

How to Replace the Main Body Stabilizing Pins

- With the pin cover down, push the right or left part up as shown in the figure to remove it.
- Pull out the pin in the direction of the arrow in the figure.
*If difficult to pull out, use a thin object to press the red part shown in the figure.
- Install the new pin, and attach the pin cover in the correct direction. Be sure to push the pin cover down from the middle of the top edge.

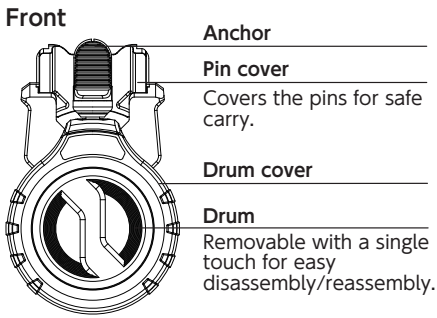
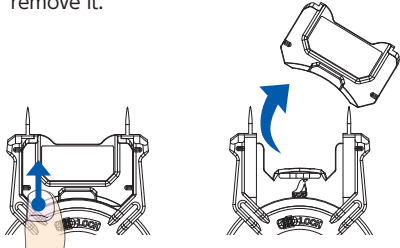

Replacement Part

Item Code **77453**
Replacement Main Body Stabilizing Pins 2 pc-pack for Thread Reel II

Caution

Be careful not to prick your fingers on the pins.

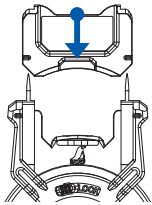

Warning

- The anchor pin is sharp and dangerous. For your safety, do not remove the anchor pin by pulling out the thread.
- Pay attention to the anchor pin when winding the thread. For your safety, please wear safety goggles.
- To rewind the thread, press on the drum and adjust the speed of the anchor while safely rewinding.

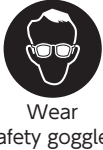

Caution

- Using a damaged thread can cause malfunction. If the thread becomes damaged, immediately cut the damaged portion and reattach the anchor.

How to Replace the Thread

Disassembly

- Release the spring charge.
- Separate the anchor, turn the drum cover counter-clockwise, and remove the drum cover.

Thread Replacement

- Take out the drum and guide the old thread out, then wind the new thread.
 - Make a knot at the tip of the new thread, and make a loop as in Figure A on the right,
 - Open the loop wide as in Figure B on the right.
 - Twist the loop as in Figure C on the right, and overlap the two smaller loops as in Figure D on the right.
 - Push the drum through the two loops as in Figure E on the right, and gently pull to fasten. Once fastened, turn the drum over and reel in the thread in the wind-up direction.

Assembly

- Place the drum back into its original place and guide the thread through as in the figure on the right.
- Replace the drum cover, and turn clockwise to fasten.
- Charge the spring after attaching the anchor.

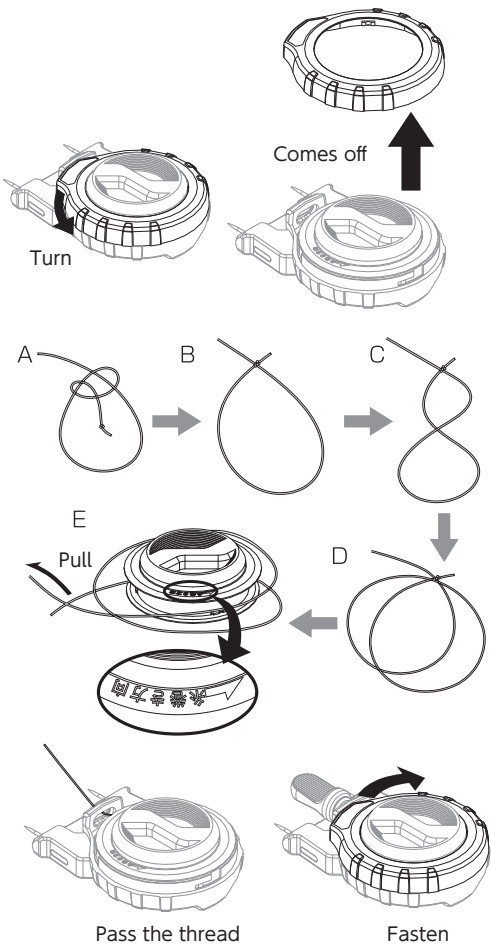

Attaching the Anchor

*When replacing the anchor, slide the drum fastener switch so it reads LOCK to prevent drum rotation and hold the thread in place. This is safe and convenient when the thread gets tangled or when replacing the anchor.

- Make a knot at the tip of the thread, and make a loop as shown in the figure on the right.
- Hook the thread around the anchor's groove, and pull the longer thread until the anchor will not slip out. Cut off the shorter thread.
- Twist the thread to make a loop, then hook it around the anchor pin to complete.

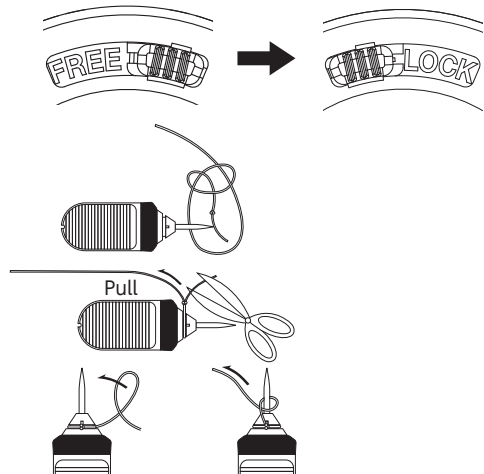

8 m Auto-rewind Type

15 m of thread is wound up. Able to automatically rewind 8 m of thread. Will need to be rewound manually if more than 8 m of thread is pulled out. The spring has already been charged.

How to Rewind the Thread

Wind 8 m of thread with the spring's power. To rewind more than 8 m of thread, first rewind 8 m with the spring's power, and then turn the drum to manually rewind the remaining thread as illustrated in the diagram to the right. Please charge the spring after the anchor has been completely stowed away.

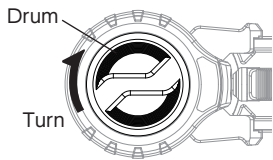

How to Charge/Release the Spring

How to Charge the Spring

Turn the spring adjustment knob on the back side of the main body 3 or 4 times in the direction to charge the spring. Pull the anchor to make sure it works properly before use.

How to Release the Spring

Press the release switch on the back side of the main body several times until the spring loses its winding power.

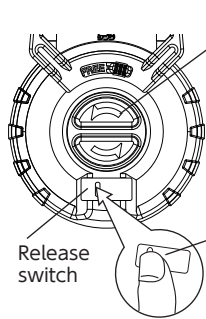

Spring adjustment knob

Caution

Do not turn the spring adjustment knob in the opposite direction, as this may cause malfunction.

Press here

Release switch

Instructions

- Remove the anchor from the pin cover and with the thread slightly pulled out, slide the fastener switch so it reads LOCK.
- Place your finger on the pin cover's top edge and push it down as shown in Figure B.
*The pins are concealed on both sides. Take care when pushing down.
- Hold the anchor, slide the fastener switch so it reads FREE, and pin the anchor as desired. Pull out the thread so that it is taut, and stick the main body's stabilizing pins in the desired position to secure the main body.
- When storing, return the pin cover and anchor to their original positions. To make it easier to operate the pin cover, wind up the thread leaving only a slight amount pulled out as in step (1), and slide the fastener switch so it reads LOCK.

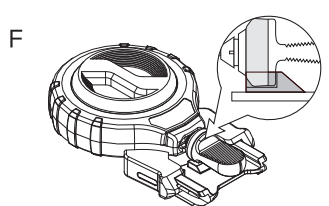
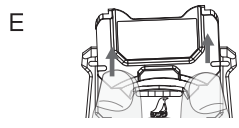
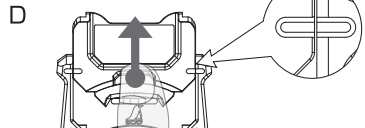
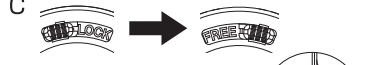
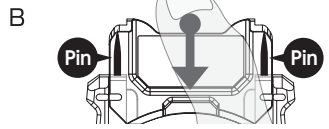
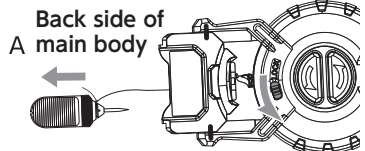

Next, place your finger on the bottom edge of the pin cover and push it up as shown in Figure D, aligning the marks on the pin cover with the marks on the main body. If the marks do not align properly, raise the pin cover one side at a time as shown in Figure E to make alignment easier.

*Trying to raise the pin cover by force is dangerous as the pin cover could fly off. If one side ends up above the mark, lower it below the mark.

Return the anchor to its original position on the pin cover and slide the fastener switch so it reads FREE. Wind up the thread before storing.
*Insert the anchor pin into the thread mouth as shown in Figure F, and hook the anchor onto the protrusion of the pin cover to secure the cover.

Specifications

Material	Body: ABS resin, polyacetal resin, stainless steel
	Spring: Stainless steel
Thread	Anchor: ABS resin, spring steel, rubber
	Main Body Stabilizing Pin: ABS resin, spring steel
Body Size	Thread: Nylon
Thread	Φ0.6 mm×15 m
Body Size	110×69×31 mm
Weight	90 g

Shinwa Rules Co., Ltd.
3-18-21 Koya, Sanjo,
Niigata, 955-8577 JAPAN
<https://www.shinwasokutei.co.jp/english/>
MADE IN CHINA

